



TECHNICAL DATACARD

COVERING PADEL STRUCTURE

Three conditions have been taken into account for the cover model developed by Sky Padel: aesthetics, functionality and economy.

SKYPADEL COVERING STRUCTURE COMPRISES:

Metal perimeter structure consisting of:

- Aluminium structure pillars measuring 6 m high, with 500x800x30 anchor plates and chemical anchors to secure to the footing.
 - Aluminum profile beams between pillars, at a height of 7 m.
 - Extruded aluminium substructure to support the awning cover, fitted with Tenkeder profiles to tension the awning. 260x4x116x7 CA profiles and 60x3x60x3 trusses.
 - Side awning system to prevent gusty rain, fully integrated in the cover structure (height to be determined by the customer).
 - Ultramodern PVC-coated awning, translucent 680 g per sqm, M2 fireproof, with UVA treatment, pre-stressed and easy to maintain.
 - Ultramodern micro-perforated awning for the cover's gable ends.
 - Secured to the padel court's pillars for lower wind resistance, greater luminosity and improved ventilation of the volume contained by the cover.
- * The covers require a technical project (with a geotechnical study of the terrain) in order to calculate the structures and to define the steel and aluminium profiles and the dimensions of the footings.

PORTICO TYPE

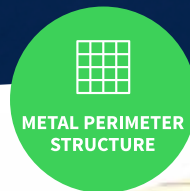
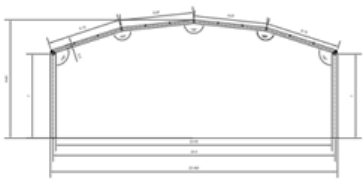

Months of technical development and aesthetic tweaks have created a model for several padel courts, designed to withstand winds up to 100 km/h.

